

LUXA SCALLOP Architectural Accent



Product Code LUXASCAL.1.3000.90.P.SI

LUXA Scallop with 1.1W, 3000K, 90 CRI, 26lm, 90° light engine. IP20 clear glass & remote Phase Cut control gear.

Variety of finishes available.

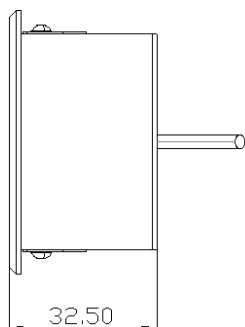
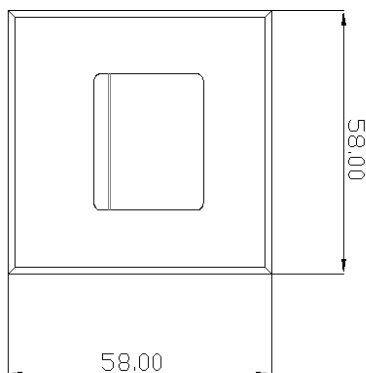

Variant	LUXA Scallop
Adjustability	Fixed
CCT Channel	3000K
CRI	90
Current	350mA
Driver	Phase cut
Driver type	Remote
Forward Voltage	3V
Glass	Clear
Install Method	Wall recessed
IP Rating	IP20
Lamp Life	50,000hrs
Lamp Wattage	1.1W
Lumen output	26 lm
Operating temperature	-10° to +55°
Light Source	Single colour
Trim finish	Anodised silver
Voltage	110-240V