



## LUXA MINI Architectural In-ground

Product Code LUXAMINI.1.3000.15.P.ASV

LUXA Mini with 1.1W, 3000K, 90 CRI, 102lm, 15° light engine. IP20 clear glass & remote Phase cut control gear.

Variety of finishes available.

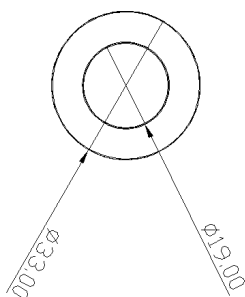
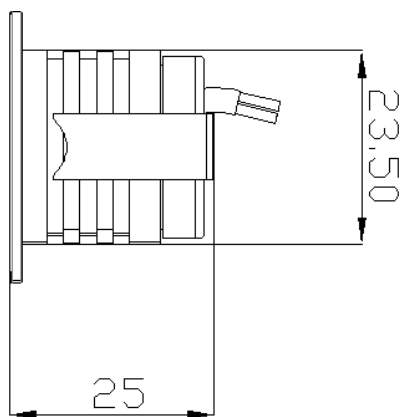

<b>Variant</b>	LUXA Mini
<b>Adjustability</b>	Fixed
<b>Beam Angle</b>	15°
<b>CCT Channel</b>	3000K
<b>CRI</b>	90
<b>Current</b>	350mA
<b>Driver</b>	Phase
<b>Driver type</b>	Remote
<b>Forward Voltage</b>	3V
<b>Glass</b>	Clear
<b>Install Method</b>	Ground recessed
<b>IP Rating</b>	IP20
<b>Lamp Life</b>	50,000hrs
<b>Lamp Wattage</b>	1.1W
<b>Lumen output</b>	102 lm
<b>Operating temperature</b>	-10° to +55°
<b>Light Source</b>	Single colour
<b>Trim finish</b>	Anodised Silver
<b>Voltage</b>	110-240V