

LUXA MINI Architectural In-ground



Product Code LUXAMINI.1.2700.15.D.WH

LUXA Mini with 1.1W, 2700K, 90 CRI, 102lm, 15° light engine. IP20 clear glass & remote DALI control gear.

Variety of finishes available.

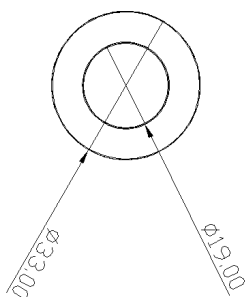
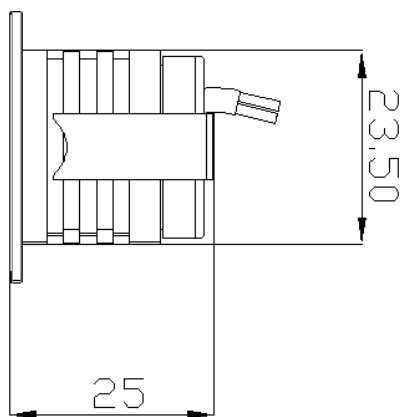

Variant	LUXA Mini
Adjustability	Fixed
Beam Angle	15°
CCT Channel	2700K
CRI	90
Current	350mA
Driver	DALI
Driver type	Remote
Forward Voltage	3V
Glass	Clear
Install Method	Ground recessed
IP Rating	IP20
Lamp Life	50,000hrs
Lamp Wattage	1.1W
Lumen output	102 lm
Operating temperature	-10° to +55°
Light Source	Single colour
Trim finish	White
Voltage	110-240V