



## LITA MIDI Baffled Architectural In-ground

Product Code LITAMIDIBAF.30.9.BZ

Lita Midi Baffled with 2.1W, 3000K, 90 CRI, 105lm, 9° light engine. IP67 clear glass & remote Phase Cut control gear.

Finishes available

Black (BK), Brass (BS), Bronze (BE), Brushed Stainless (BSS), Copper (CR), Polished Stainless Steel (PSS), Silver (SR), White (WE)

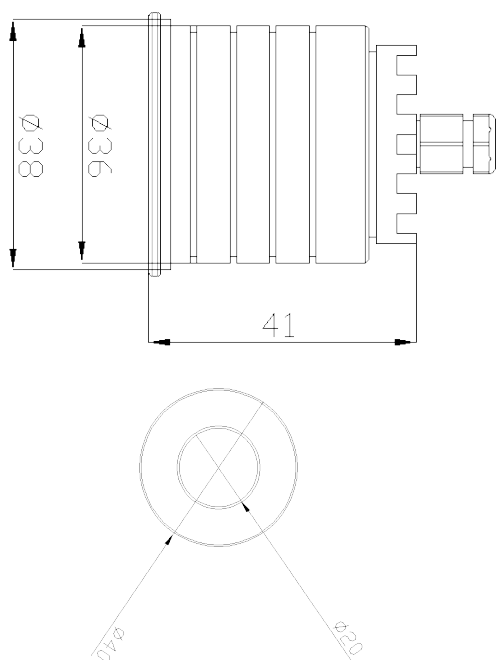

<b>Variant</b>	Lita Midi Baffled
<b>Adjustability</b>	Fixed
<b>Baffle Finish</b>	Black
<b>Beam Angle</b>	9°
<b>CCT Channel</b>	3000K
<b>CRI</b>	90
<b>Current</b>	700mA
<b>Driver</b>	Phase cut
<b>Driver type</b>	Remote
<b>Forward Voltage</b>	3V
<b>Glass</b>	Clear
<b>Install Method</b>	Ground recessed
<b>IP Rating</b>	IP67
<b>Lamp Life</b>	50,000hrs
<b>Lamp Wattage</b>	2.1W
<b>Lumen output</b>	751 lm
<b>Operating temperature</b>	-10° to +55°
<b>Light Source</b>	Single colour
<b>Trim finish</b>	Bronze
<b>Voltage</b>	110-240V