

FARO MINI WALL ON-OFF DRIVER (DIP-SWITCH)

FAROMINIW.DRIVER.ON-OFF

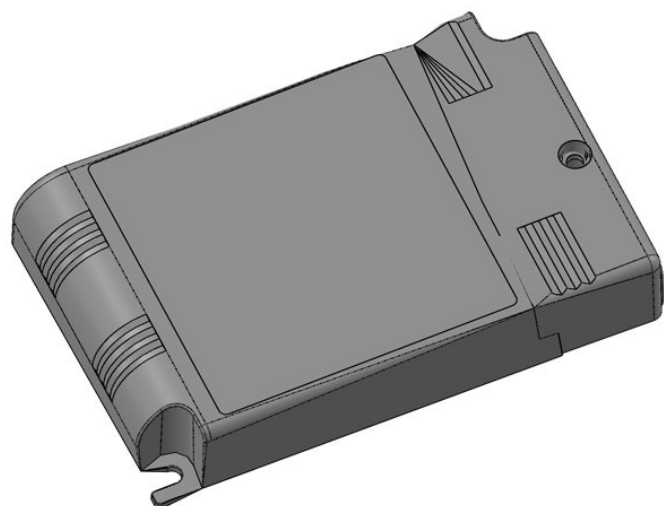

Product Information

FARO MINI WALL
ON-OFF Driver (DIP-SWITCH)

| | |
|----------------------------------|---------------------------|
| Type | LED Driver 38W |
| Size / Weight | 146.5x43.5x30mm / 122g |
| Protocol | DIP-SWITCH |
| Ingress Protection | IP20 |
| Available IP Box (on request) | IP67 Box for power supply |