

FARO MINI SPIKE ON-OFF DRIVER (DIP-SWITCH)

FAROMINISPIKE.DRIVER.ON-OFF

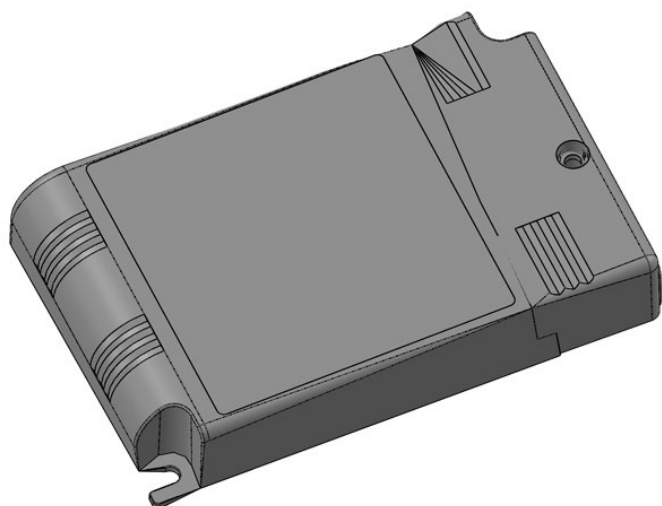

Product Information

FARO MINI SPIKE
ON-OFF Driver (DIP-SWITCH)

Type	LED Driver 38W
Size / Weight	146.5x43.5x30mm / 122g
Protocol	DIP-SWITCH
Ingress Protection	IP20
Available IP Box (on request)	IP67 Box for power supply